

WORKSITE TRAFFIC CONTROL PLAN GENERAL NOTES

- 1. THIS STAGE OF WORK IS FOR ...
2. THE PROPOSED START DATE FOR THIS WTCP IS ...
3. CONTACT XXXXX AT () FOR CONSTRUCTION PERSONNEL RESPONSIBLE FOR WTCP IMPLEMENTATION/MAINTENANCE.

NOTIFICATIONS & APPROVALS

- 1. CONTRACTOR SHALL CONTACT THE LADOT TEMPORARY TRAFFIC MANAGEMENT SECTION'S ENGINEER AT EDGAR.RODRIGUEZ@LACITY.ORG AT LEAST FIVE (5) WORKING DAYS ...
2. PERMITTEE SHALL COORDINATE WITH THE IMPACTED TRANSIT OPERATOR(S) PRIOR TO PLAN SUBMISSION ...
3. WHENEVER ANY ACTUAL OR PROPOSED CONSTRUCTION ACTIVITY OCCURS WITHIN 5' OF ANY EXISTING CITY TRANSIT FURNITURE ...

TYPICAL CONTRACTOR RESPONSIBILITIES

- 1. THE STRIPING AND SIGNAGE SHOWN FOR REMOVAL ON THESE PLANS MAY BE DIFFERENT THAN WHAT EXISTS AT TIME OF IMPLEMENTATION ...
2. ALL TRAFFIC CONTROL DEVICES SHALL BE KEPT IN THEIR PROPER POSITION AT ALL TIMES, AND SHALL BE REPAIRED, REPLACED OR CLEANED ...

TEMPORARY CRASH CUSHION INSTALLATION NOTES

- 1. X INDICATES SAND FILLED MODULE LOCATION AND WEIGHT OF SAND IN POUNDS FOR EACH MODULE. MODULE SPACING IS BASED ON THE GREATER DIAMETER OF THE MODULE.
2. ALL SAND WEIGHTS ARE NOMINAL.
3. THE TEMPORARY CRASH CUSHION ARRAYS SHOWN ON THE PLANS SHALL BE USED ONLY IN LOCATIONS WHERE THERE WILL BE TRAFFIC ON ONE SIDE OF THE TEMPORARY CRASH CUSHION ARRAY.

Pursuant to the California Business and Professions Code, this plan is prepared by and under the responsible charge of work of, the named consulting firm and California Registered Engineers shown below.

Professional Engineer stamps for CIVIL and TRAFFIC disciplines. Includes fields for name, number, and expiration date.

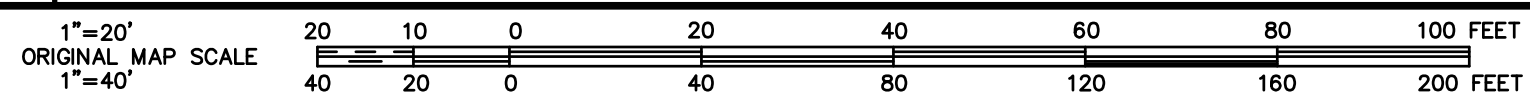

- 4. IF THE FIXED OBJECT OR APPROACH END OF THE TEMPORARY RAILING IS LESS THAN 15'-0" FROM THE EDGE OF THE TRAVELED WAY, A TEMPORARY CRASH CUSHION ARRAY IS REQUIRED ...
5. TEMPORARY CRASH CUSHION ARRAYS SHALL NOT ENCROACH ON THE TRAVELED WAY.
6. ARRAYS FOR MEDIAN SHOULDERS SHALL CONFORM TO DETAILS SHOWN ON THIS PLAN FOR OUTSIDE SHOULDERS.
7. PLACE THE TYPE P MARKER PANEL SO THAT THE BOTTOM OF THE PANEL RESTS UPON THE PALLET AND FACES TRAFFIC.

TYPICAL IMPLEMENTATION REQUIREMENTS

- 1. THE CONTRACTOR SHALL BE RESPONSIBLE FOR LABOR AND MATERIAL INVOLVED IN THE REMOVAL, INSTALLATION, AND MAINTENANCE OF ALL STRIPING, PAVEMENT MARKINGS, SIGNS, BARRICADES, DELINEATORS, ETC. ...
2. ALL CONSTRUCTION RELATED WARNING SIGNS SHALL BE IN BLACK LEGEND WITH ORANGE BACKGROUND AND IN CONFORMANCE WITH THE CALIFORNIA MANUAL ON UNIFORM TRAFFIC CONTROL DEVICES (CA M.U.T.C.D.) LATEST EDITION.
3. CONTRACTORS SHALL PROVIDE FLAGGERS AS DEEMED NECESSARY BY CITY. A FLAGGER SHALL USE ONLY THE APPROVED OCTAGONAL STOP/ SLOW PADDLE ...

RESTORATION STRIPING NOTES

- 1. THE CONTRACTOR SHALL BE RESPONSIBLE FOR LABOR AND MATERIAL INVOLVED IN THE MARKOUT, AND INSTALLATION OF ALL RESTORATION STRIPING/PAVEMENT MARKINGS. THE CONTRACTOR SHALL ALSO BE RESPONSIBLE FOR REMOVAL OF ALL CONFLICTING WTCP STRIPING, SIGNING, AND OTHER WTCP-RELATED TRAFFIC CONTROL DEVICES PRIOR TO THE INSTALLATION OF THE FINAL STRIPING.
2. THE CONTRACTOR SHALL BE RESPONSIBLE FOR THE REPAINTING OF ALL EXISTING STRIPING THAT HAS BEEN DAMAGED DURING THE CONSTRUCTION PROCESS.
3. MARKOUT SHALL BE BY HEAVY PAINT BRUSH MARKINGS OVER A PULLED ROPE IN THE RESPECTIVE WHITE AND YELLOW COLORS OF THE PROPOSED STRIPING ...

LEGEND:

- 1. - EXISTING STRIPING & MARKINGS TO REMAIN
- EXISTING STRIPING & MARKINGS TO BE REMOVED
- PROPOSED STRIPING & MARKINGS
2. - EXISTING RED CURB MARKINGS TO REMAIN
- EXISTING RED CURB MARKINGS TO BE REMOVED
- PROPOSED RED CURB MARKINGS
3. - EXISTING SIGN AND POST
- EXISTING SIGN AND POST TO BE REMOVED OR RELOCATED
- PROPOSED SIGN AND POST

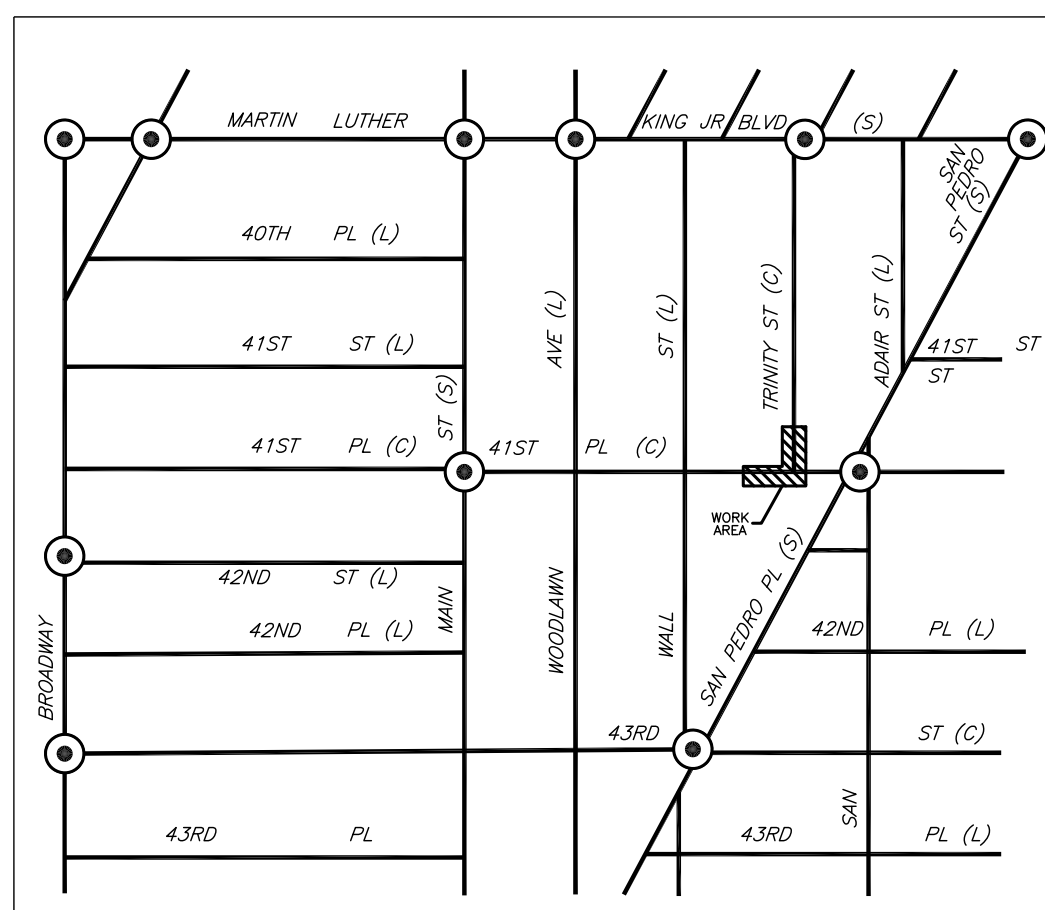
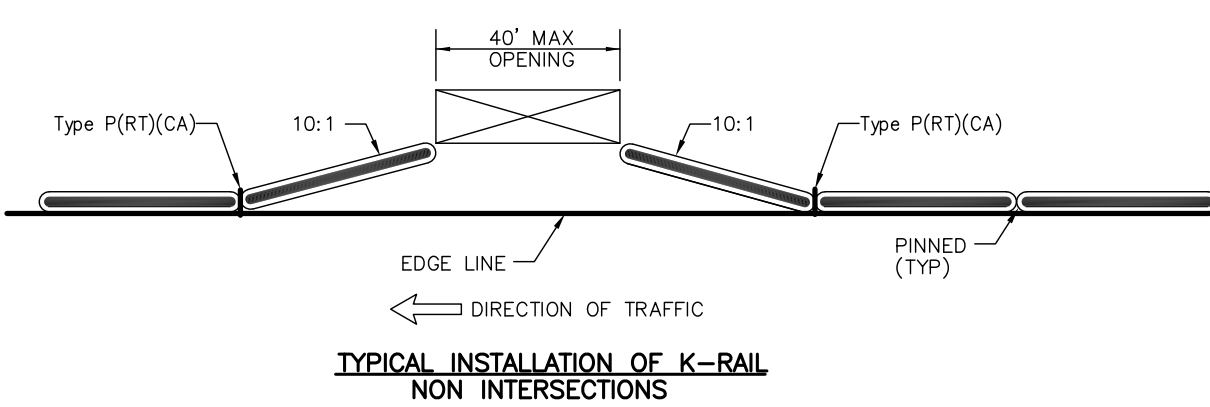

VICINITY MAP NOT TO SCALE

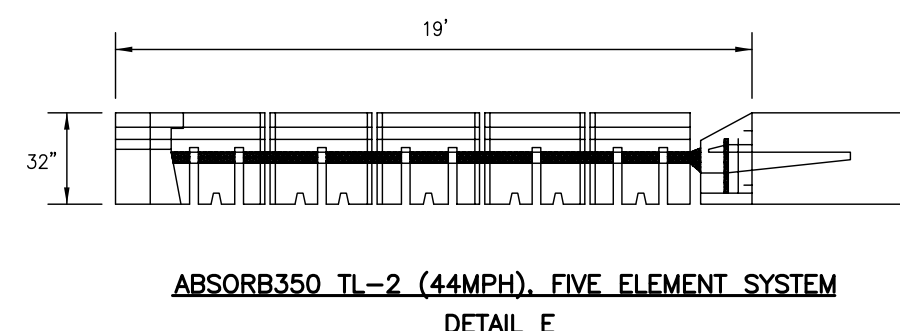

ABSORB350 TL-2 (44MPH) FIVE ELEMENT SYSTEM DETAIL E

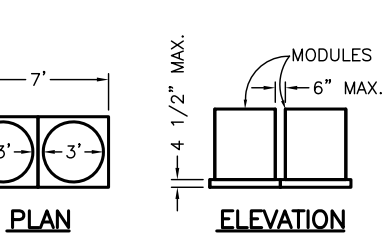

CRASH CUSHION PALLET DETAIL A (TO BE USED AT THE DISCRETION OF THE CONTRACTOR)

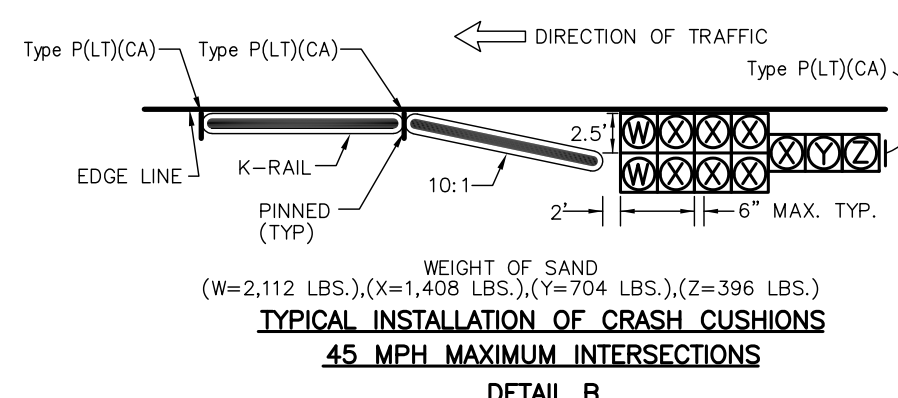

TYPICAL INSTALLATION OF CRASH CUSHIONS 45 MPH MAXIMUM INTERSECTIONS DETAIL B

THIS WORKSITE TRAFFIC CONTROL PLAN IS NOT A PERMIT

DEPARTMENT OF TRANSPORTATION ACCEPTANCE OF THIS PLAN DOES NOT CONSTITUTE CITY APPROVAL OF THE STREET, LANE AND/OR SIDEWALK CLOSURE(S) DEPICTED ON THIS PLAN.

LADOT HAS DETERMINED THERE WILL BE SIGNIFICANT IMPACT TO TRAFFIC CIRCULATION DUE TO THE REQUESTED EXEMPTION FOR LANE CLOSURES DURING PEAK PERIODS. LADOT'S ACCEPTANCE OF THIS WORK SITE PLAN DOES NOT CONSTITUTE A MITIGATION FOR SUCH AN IMPACT.

PURSUANT TO THE STATE OF CALIFORNIA PROFESSIONAL ENGINEERS ACT, BUSINESS AND PROFESSIONAL CODE SECTION 6703, THE RESPONSIBLE CHARGE OF WORK FOR THE ENGINEER OF RECORD INCLUDES THE INVESTIGATION OF SITE CONDITIONS NECESSARY TO SUPPORT THE DESIGN OF PROFESSIONAL ENGINEERING WORK.

TEMPORARY TRAFFIC CONTROL PROJECT ADDRESS/PHASE # ESTIMATED CONSTRUCTION DURATION: XX WEEKS

Approval table with fields for REVIEWED, ACCEPTED, TRANSPORTATION ENGINEER, SENIOR TRANSPORTATION ENGINEER, INSTALLATION DATES, and PROJECT NO. Includes DEPARTMENT OF TRANSPORTATION logo and MAJOR STREET LIMITS OR CROSS STREET info.

Revision table with columns for DATE, BY, REVISION, and DESCRIPTION.

CONSTRUCTION NOTES:

- CONTRACTOR SHALL NOTIFY ALL AFFECTED RESIDENTS, LAPD LAFD, SCHOOLS, COUNCIL OFFICES AND BUSINESSES FIVE (5) WORKING DAYS PRIOR TO START OF WORK
- CONTRACTOR SHALL PROVIDE REFLECTORIZED CONES AT TYPE III BARRICADE SUPPORTS TO ALERT PEDESTRIANS OF THE BARRICADE SUPPORT.
- CONTRACTOR SHALL CONTACT THE LADOT PARKING METERS DIVISION AT (213) 473-8270, TEN (10) WORKING DAYS PRIOR TO START OF AND END OF CONSTRUCTION TO ARRANGE AND COORDINATE FOR ANY PARKING METER OR PAY STATION RELATED WORK. THIS WORK INCLUDES, BUT IS NOT LIMITED TO, THE TEMPORARY OR PERMANENT REMOVAL, INSTALLATION, OR RELOCATION OF ANY PARKING METER, PAY STATION, METER POSTS, PARKING SENSORS, PARKING SIGNS, SIGN POSTS, PARKING SPACE NUMBERS, CURB PAINTING, PAVEMENT MARKINGS, AND ANY OTHER RELATED ITEMS DEEMED NECESSARY BY LADOT. CONTRACTOR SHALL PAY THE LADOT PARKING METERS DIVISION FOR INSTALLATION AND REMOVAL COSTS UPON RECEIVING AN INVOICE FOR WORK AS DESCRIBED ABOVE. OCCASIONALLY, PAYMENT MAY BE DEDUCTED FROM THE DEVELOPER'S OR CONTRACTOR'S B-PERMIT DEPOSIT FOR THE PROJECT. FAILURE TO NOTIFY LADOT WILL CAUSE THE CONTRACTOR TO BE LIABLE FOR ANY MISSING OR DAMAGED PARKING METER, PAY STATION, SENSORS, POSTS, SIGNS, ETC., THAT LADOT RECORDS INDICATE ARE PRESENT. UPON APPROVAL BY THE LADOT PARKING METERS DIVISION, CONTRACTOR MAY REMOVE AND DISPOSE OF AFFECTED PARKING METER POSTS IN CONJUNCTION WITH THEIR SIDEWALK DEMOLITION WORK, BUT ONLY AFTER LADOT HAS REMOVED THE PARKING METER HEADS AND ALL METER POST MOUNTED SIGNS, WHERE APPLICABLE. PERMANENT REMOVAL OF EACH ON-STREET METERED PARKING SPACE WILL REQUIRE PAYMENT TO LADOT'S PARKING METER DIVISION FOR THE CALCULATED ANNUAL REVENUE AMOUNT PROJECTED OVER A TEN-YEAR PERIOD. IN ADDITION, TEMPORARY REMOVAL OF ANY PARKING METERS LASTING OVER 30 DAYS WILL ALSO REQUIRE PAYMENT OF A CALCULATED REVENUE FOR THE LENGTH OF TIME THE METERS ARE OUT OF SERVICE BEYOND THE INITIAL 30 DAYS. FULL PAYMENT IS REQUIRED AS A CONDITION OF THE PERMIT AND IS REQUIRED OF THE APPLICANT BEFORE LADOT WILL PROVIDE ITS FINAL APPROVAL.
- CONTRACTOR SHALL PIN ANGLED K-RAIL TO PAVEMENT PER CALTRANS STANDARD PLAN T3B.
- CONTRACTOR SHALL ADA COMPLIANT 5' MINIMUM WALKWAY
- CONTRACTOR SHALL INSTALL A TEMPORARY ADA COMPLIANT RAMP.

TEMPORARY STRIPING NOTES:

- ALL STRIPING SHALL CONFORM TO THE 2014 CA MUTCD AND SHALL BE INSTALLED WITH THERMOPLASTIC PER LADOT SPECIFICATIONS
- REMOVE ALL CONFLICTING STRIPING PRIOR TO INSTALLATION OF WTCP/TCP.
 - WHEN REMOVAL IS REQUIRED BY CONSTRUCTION, CROSSWALK MARKINGS AND PEDESTRIAN SIGNAL HEADS SHALL BE REMOVED SIMULTANEOUSLY.
 - BUBBLE NOTES ARE:
 - 8" WHITE CHANNELIZING LINE, DETAIL 38A
 - 4" WHITE EDGE LINE, DETAIL 27B
 - 4" DOUBLE YELLOW LINE WITH REFLECTIVE MARKERS, DETAIL 22
 - SHARROW SYMBOL PAVEMENT MARKING

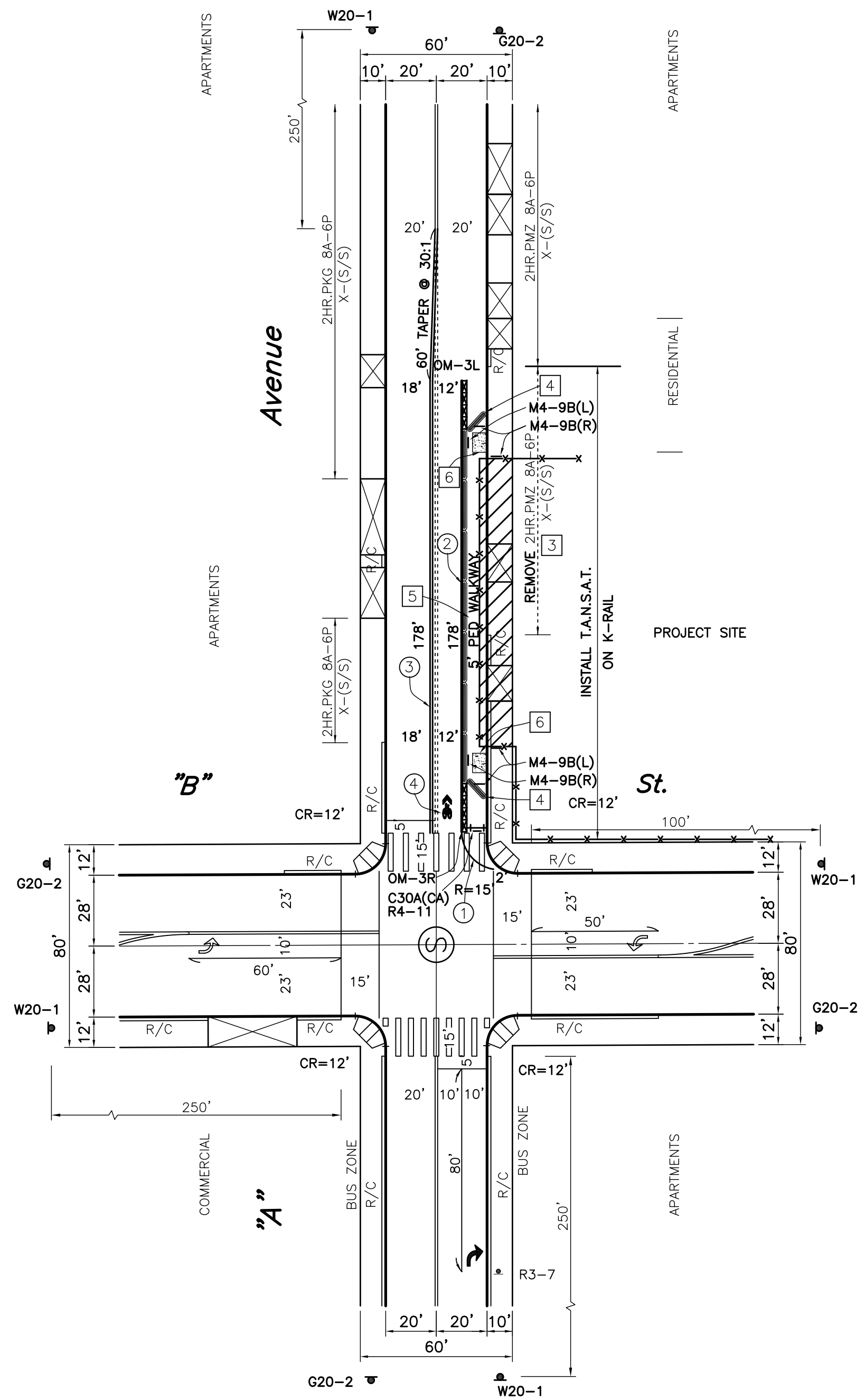

PURSUANT TO THE STATE OF CALIFORNIA PROFESSIONAL ENGINEERS ACT, BUSINESS AND PROFESSIONAL CODE SECTION 6703, THE RESPONSIBLE CHARGE OF WORK FOR THE ENGINEER OF RECORD INCLUDES THE INVESTIGATION OF SITE CONDITIONS NECESSARY TO SUPPORT THE DESIGN OF PROFESSIONAL ENGINEERING WORK.

TEMPORARY TRAFFIC CONTROL
PROJECT ADDRESS/PHASE #
ESTIMATED CONSTRUCTION DURATION: XX WEEKS

REVIEWED	20	ACCEPTED	20
Transportation Engineer		Senior Transportation Engineer	
INSTALLATION DATES		CITY OF LOS ANGELES DEPARTMENT OF TRANSPORTATION SELETA J. REYNOLDS, GENERAL MANAGER	
MARKOUT BEGAN:		"A" AVENUE BET "B" STREET AND "C" STREET	
MARKOUT COMPLETED:		IF THIS PLAN HAS NOT BEEN IMPLEMENTED WITHIN TWO (2) YEARS OF THE ACCEPTANCE DATE, IT MUST BE RESUBMITTED TO LADOT PERMIT PLAN REVIEW SECTION FOR REVIEW AND MAY REQUIRE A SUBSEQUENT ACCEPTANCE.	
STRIPING COMPLETED:		PROJECT NO. B-PERMIT#	
References: XXXX		DRAWING NO. D-XXXX	
Thomas Guide	District	PROJECT NO.	DRAWING NO.
XXX-XX	XX	B-PERMIT#	D-XXXX

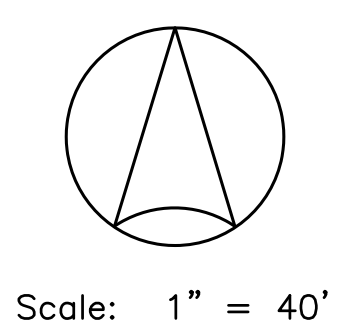

Pursuant to the California Business and Professions Code, this plan is prepared by and under the responsible charge of work of, the named consulting firm and California Registered Engineers shown below.

PRIVATE CONSULTANT LOGO/ADDRESS		
---------------------------------	--	--

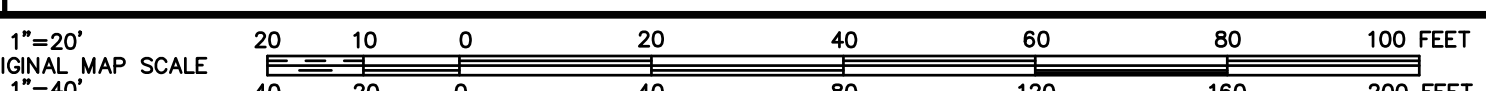

ROAD WORK AHEAD	END ROAD WORK
W20-1	G20-2
DETOUR	DETOUR
M4-9B(L)	M4-9B(R)
OM-3R	OM-3L
SHOULDER CLOSED	MAY USE FULL LANE
C30A(CA)	R4-11
DATE	DATE
BY	BY
REVIEWED	REVIEWED
DISTRICT	DISTRICT
SIGNALS	SIGNALS
DATE	DATE
BY	BY
SR. T.E.	SR. T.E.
T.E.	T.E.
REVISION DESCRIPTION	REVISION DESCRIPTION
NO.	NO.